

**Notes**  
Do not scale from this drawing unless for planning purposes. Finished dimensions only are to be used. All dimensions must be checked on site by the Contractor prior to the commencement of any construction or building works. Where applicable, dimensions and details are to be used in conjunction with specialist consultant's drawings, any discrepancy between drawings is to be brought to the attention of Jon J Steel prior to the commencement of any foundation or building works. This drawing is the property of Jon J Steel and may not be reproduced without their permission.

Revisions		date
rev	notes	
A	Existing rooflight shown	13.02.14

THIS COPY HAS BEEN MADE BY OR WITH THE AUTHORITY OF RYedale DISTRICT COUNCIL PURSUANT TO SECTION 41 OF THE COPYRIGHT, DESIGN AND PATENTS ACT 1988 UNLESS OTHERWISE INDICATED. ANY REPRODUCTION OF THIS COPY WITHOUT THE WRITTEN PERMISSION OF THE COPYRIGHT OWNER IS PROHIBITED.

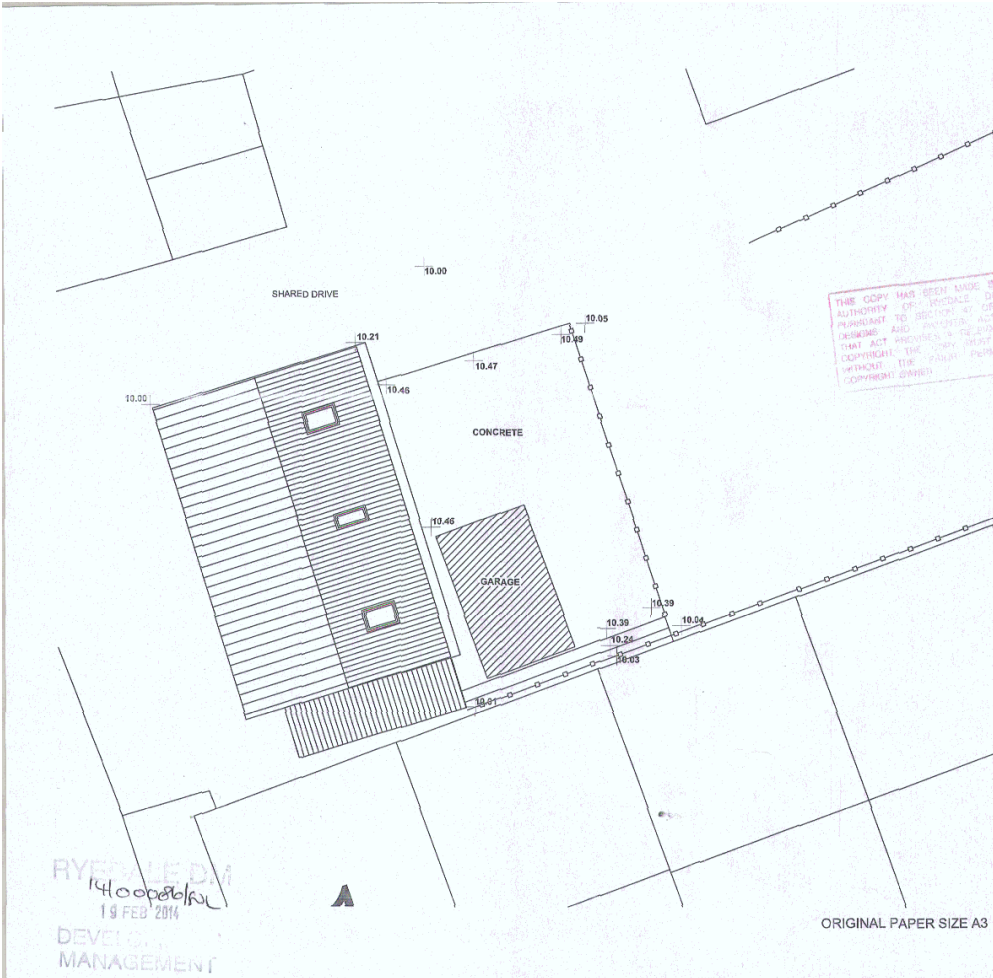

<b>Jon J Steel</b> BSc (Hons) MA (Bldg Con) MRICS <b>Chartered Building Surveyor</b>			
<small>Regulated by RICS</small>			
<b>Project</b> The Feathers Hotel, Market Place, Helmsley YO62 5BH		<b>Client</b> Richard Murray Wells	
<b>Drawing</b> Land to rear of hotel - Site and roof plan as existing	<b>Scale</b> 1:200	<b>Number</b> 016213-02	<b>Revision</b> A
<b>Status</b> Survey		<b>Date</b> November 2013	
<small>9 Georges Place, George Street, Pocklington, York YO42 2DF          Tel/Fax 01759 304588 E-mail info@jonjsteel.co.uk Web www.jonjsteel.co.uk</small>			

RYedale DM  
 140088/14  
 19 FEB 2014  
 DEVELOPMENT  
 MANAGEMENT

ORIGINAL PAPER SIZE A3